

Reduces operator workload No wasting time

NEW Newly developed "Air Scudo® (patented)"
airflow control function



Continuous Inkjet Printer

KGK JET CCS7000

Buildup-free print head

Kishu Giken Kogyo Co., Ltd. has developed "AIR SCUDO®". The air shield effect greatly reduces ink build-up inside the head. KGK tries to aim print-head cleaning number to zero.

[Airflow inside the CCS7000 print head]

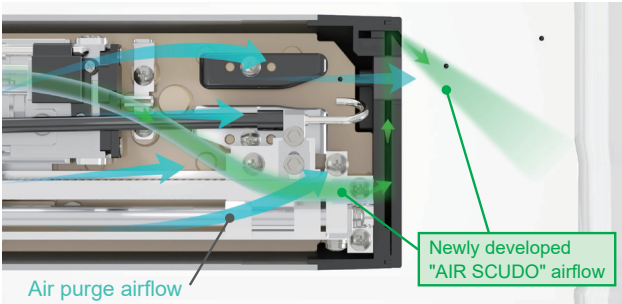

The newly developed "AIR SCUDO" function has been added to the existing KGK "Air Purge" function, which prevents ink mist from entering the print head, thereby reducing ink contamination that accumulates on the deflecting electrode. This function suppresses the generation of ink mist that causes the problem and significantly reduces ink bounce back into the print head.

This has resulted in a significant reduction in head cleaning by operators.

[Comparison of ink buildup on deflection electrode]

No AIR SCUDO® Air purge airflow + AIR SCUDO®



After 1 million print

After **10 million** print



World's fastest printing-start

The nozzle capping mechanism enables to start printing in only 24 seconds from standstill (the fastest in the world). Moving from the printable state to the standstill, it is possible in approximately 16 seconds



[Nozzle capping mechanism]

Can be used under a variety of environments

From food factories to dusty sites



The standard dustproof and waterproof rating of IP66 (limited to the main unit) allows installation in factories that handle water or in dusty locations. CE and RoHS compliant.

Tool-less replacement of consumables



The parts of the ink circulation path that require maintenance are integrated in a box for improved workability. Ink filters can be easily replaced without tools.

In case of ink leakage

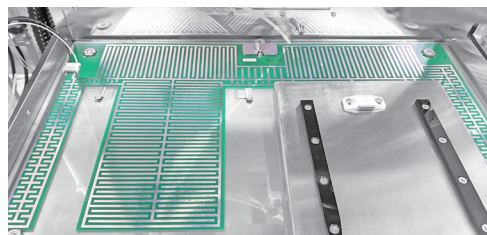

An ink leak sensor is placed on the bottom of the inkjet printer body. This sensor immediately detects and notifies you in the event of an ink leak. This prevents ink from contaminating the customer's floor.

Higher Printing Quality

賞味期限 2023. 09
製造年月 2022. 10

The optimum charge control for ink droplets is automatically selected according to the customer's printing conditions. We have achieved improved print quality by incorporating all the experience we have cultivated over the years.

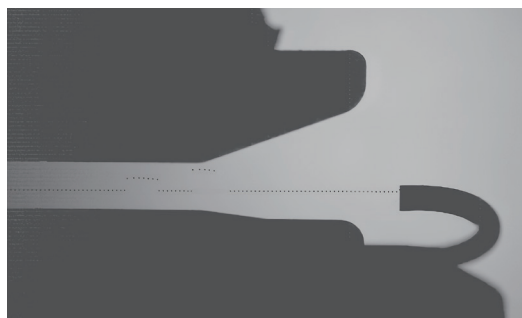

Ink drop flight evaluation with a high-speed camera

Specifications

| | |
|---|---|
| Printing method | Continuous (charge control method) |
| Supported inks | Dye ink, pigment ink |
| Dustproof and waterproof | IP66 (excluding head) |
| RoHS/CE | Supported(No UL) |
| Screen size | 10.1" color LCD/touch panel |
| Supported nozzles | 40 μm / 50 μm / 60μm |
| Character height | 0.8 to 5mm (40μm nozzle), 1 to 10mm (50μm nozzle), 2 to 10mm (60μm nozzle) |
| Max. printing speed [characters/sec] (5x5 dot font, 1 character spacing) | 2233-3666 characters/sec (varies depending on nozzle type and ink type) |
| Character type | Alphabet (upper/lower case), numbers, symbols, hiragana, katakana, kanji (JIS 1 and 2), user characters |
| Number of print rows and dot configuration (vertical x horizontal) | [1-6 columns] 5 x 5, 5 x N [1-4 columns] 7 x 5, 7 x 8, 7 x N [1-3 columns] 9 x 7, 9 x 9, 10 x 8, 12 x 10 [1-2 columns] 16 x 12, 16 x 16 [1 column] 24 x 18, 24 x 24, 32 x 24, 32 x 32 |
| Number of registered message characters | Max. 992 characters (31 characters x 32 modules) |
| Number of registered messages | Max. 1000 messages |
| Date Time (Expiration date) Print function | Year, year, month, day, day of the week, time (12/24-hour system), date throughout the year, week number throughout the year, month upper/middle/late (variable period setting), AM/PM, shift code, character assignment function (year, month, day, hour, minute, second, day of week) to another character with maximum 4 to 15 digits |
| Numbering function | Up to 10 digits, optional initial value setting, up/down, carry (1 count can be set as a work number from 1 to 9999), zero suppress function (replace or prepend zeros in upper digits with spaces), numbering character assignment function (assignment to characters other than digits), Decimal setting (2 to 36 decimal) divisible (insert any character between numbers) |
| Distance printing function | Up to 10 digits, divisible (insert any character between digits) |
| Barcode printing function | ITF, Code39, NW7, JAN, Code128, CODE93, UPC-E/GS1 |
| 2D code printing function | QR Code / Data Matrix |
| External Connection | I/O, signal light, RS-232C, LAN, encoder, UPS, USB |
| Data input | Touch panel, RS-232C communication, Ethernet |
| Multi-control | Up to 16 slave units can be controlled for 1 master unit 【Controllable functions】 Run/Stop, Power OFF, System clock setting, Message selection, Edit print contents, Numbering current value setting |
| Dry air source for Airscudo | Not required |
| Installation area (W x D x H) | Main unit: 400W x 347D x 577H (excluding protruding parts) Head: φ50mm x 222mm |
| Specification environment (temperature, humidity) | 0 to 40°C (depending on ink type), 10 to 85% (with no condensation) |
| Power source | AC90 - 264V (47 - 63Hz), 95W |
| Weight | 27Kg |
| Grounding | Class D grounding |

Product specifications are subject to change without notice.

Kishu Giken Kogyo Co., Ltd.
<https://www.kishugiken.co.jp/ew/>

Head Office 466 Nunobiki, Wakayama City,
Japan 641-0015

Email: overseas@kishugiken.co.jp